

## Sink KE Filotop Gun Metal

Kitchen Sinks

Code: 2154 056



### DETAILS

Edge/Installation Type	Flush-mount   Top-mount
Finish	PVD
Material	AISI 304 stainless steel
Coloring	Gun Metal
Texture	Foster brushed
Base	60 cm
Dimensions	490x440 mm
Standard fittings	Fixing hooks, gasket, drain, overflow and siphon, boxed packing
Mixer holes	No standard holes

Built-in hole	<a href="#">View technical data sheet</a>
---------------	---

Drainer	No
---------	----

Width	49 cm
-------	-------

Bowl dimension	450x400mm
----------------	-----------

Number of bowls	1 bowl
-----------------	--------

Waste fitting	3,5" drain
---------------	------------

## FEATURES

Gun Metal	The Gun Metal finish is obtained by treating steel with a physical process called PVD (Physical Vacuum Deposition) which deposits particles of noble metals on the surface. The result is a unique and refined aesthetic effect, and an improvement of the mechanical properties of the steel which is more resistant to impact and scratches.
-----------	--

High thickness	1mm thick steel. A significant thickness, which guarantees the maximum sturdiness and durability.
----------------	---

Basket 3,5" waste fitting	The drain is equipped with a large 3.5" drain, with the practical basket cap that prevents the discharge of solid parts.
---------------------------	--

Perimetral overflow	The overflow is always a security on the Foster sinks that prevents the overflow of water in case of oversights. The perimeter drain solution improves aesthetics thanks to its square and essential shape.
---------------------	---

Small radius	Bowls with squared shapes with a modern design and an increased capacity, for a minimal aesthetics connected with an extreme practicality.
--------------	--

## TECHNICAL DATA

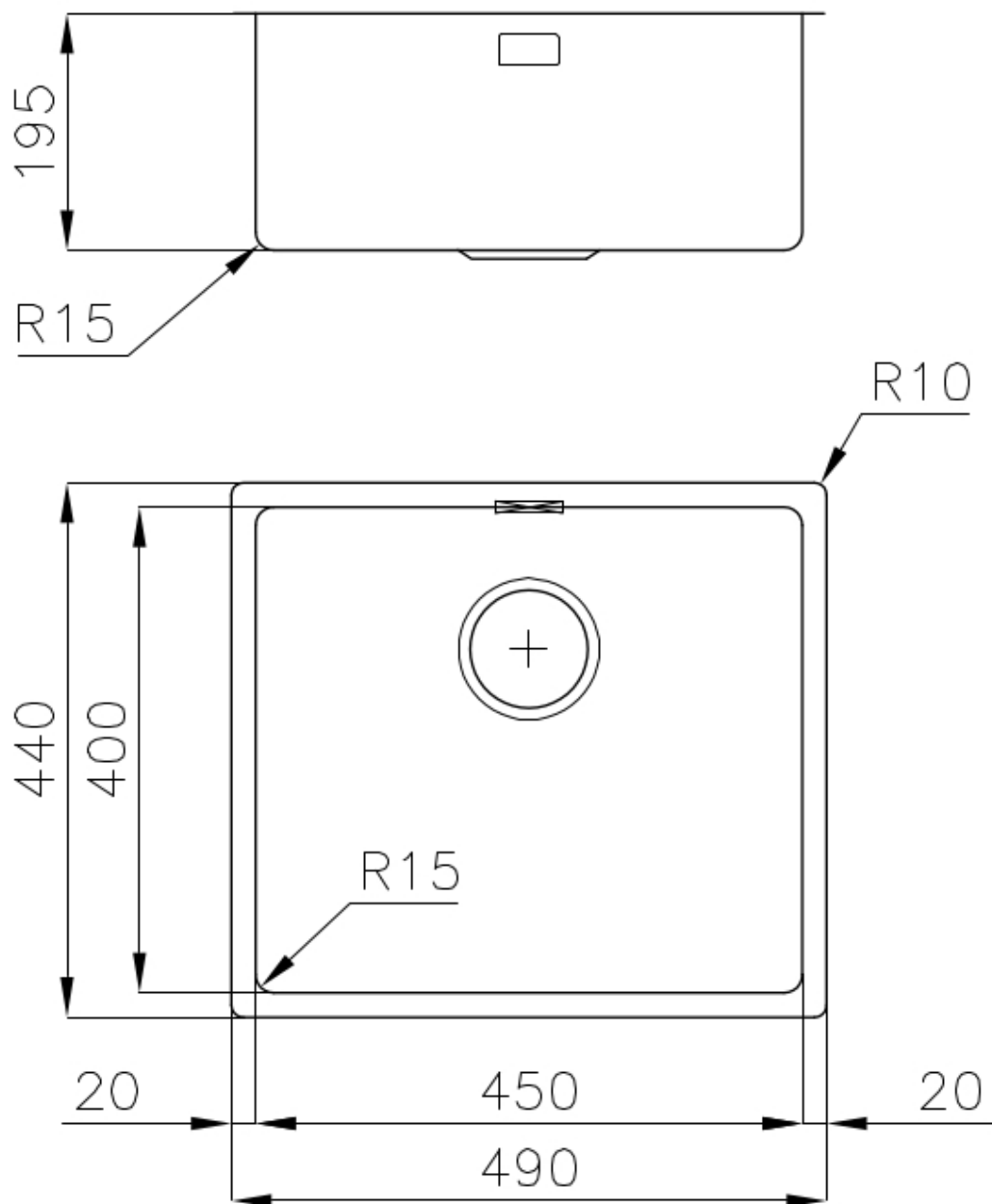

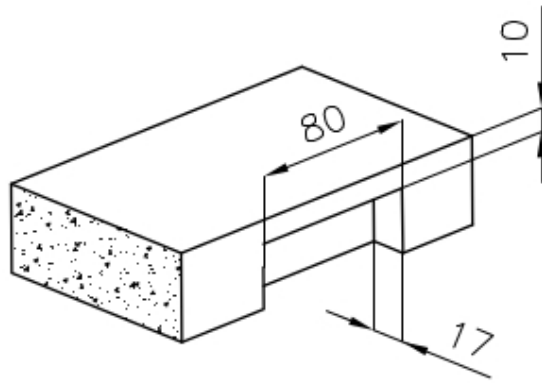

Intaglio per il troppo-pieno  
Recess for housing the over-flow

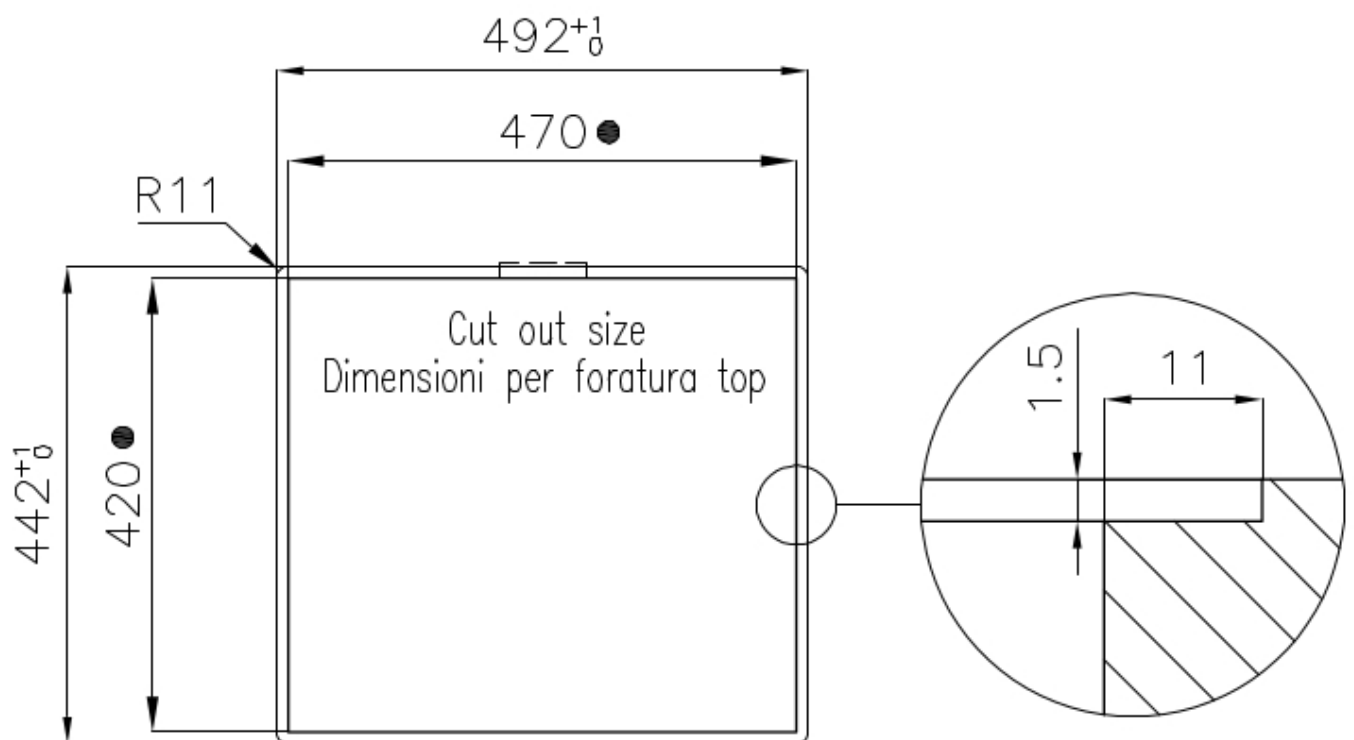

- Built-in cut out for FTS – Foratura per installazione FTS

## GALLERY

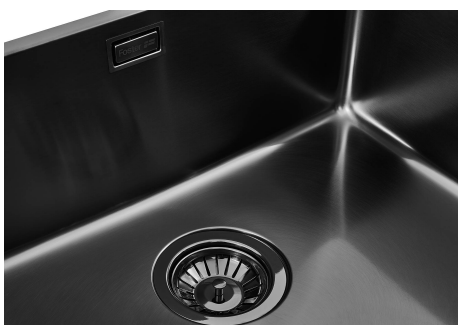

## OPTIONAL ACCESSORIES



**Cestello inox**  
8612 000



**Glass chopping board**  
8631 300



**HPDE Chopping board**  
8657 001



**HPDE Twin chopping board**  
8644 101



**Stainless steel colander**  
8154 000



**Stainless steel plate rack**  
8100 154

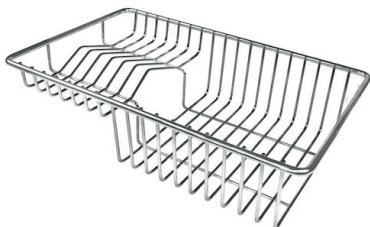

**Stainless steel plate rack**  
8100 303

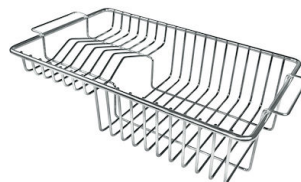

**Stainless steel plate rack**  
8100 201



**White bowl**  
8153 100

\* only in combination with the accessory  
8644 101



**Graters kit with ring-holder and food collection tray**

8159 101

\* only in combination with the accessory  
8644 101



**Stainless steel perforated tray**

8151 000

\* only in combination with the accessory  
8644 101

## RECOMMENDED PAIRINGS



**Mixer Tap Bert**

8428 100



**Mixer Tap KE**

8492 000

## OPTIONAL AUTOMATIC WASTE FITTINGS



**Gun Metal automatic waste fitting**

8407 110